

Wood Veneer Series

Contemporary Veneer Slab Doors



The epitome of modern design and function, the Wood Series of veneer slab doors offers sleek lines and curves while maintaining the natural beauty of wood. An engineered core provides strength, durability and stability. Available in a variety of standard and reconstituted veneers for your contemporary settings and choose from vertical and horizontal grain directions.



Metro

Flat Surface Profile

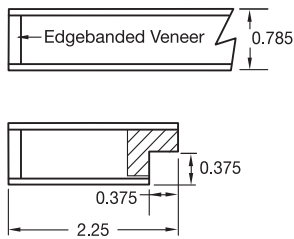

Frame



Fusion

Pillowed Surface Profile

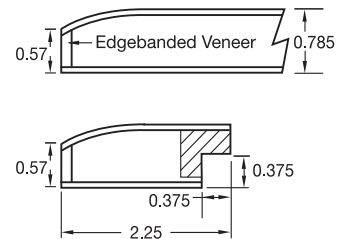

Frame

WOOD VENEER SLAB DOORS

- Available in a flat surface profile (Metro) and a pillowed surface profile (Fusion).
- Wood Veneer on face with a matching back.
- Standard 3/4" core, high quality CARB compliant engineered core. Provides a stable, consistent substrate, virtually eliminating warp common in solid wood doors.
- Edgebanding is 3mm multi-layered veneer. Gun Metal Ebony veneer is 2mm.
- Vertical grain direction is standard on both profiles. Horizontal grain direction is available with an upcharge.
- Fingerpulls and hinge boring options are available.

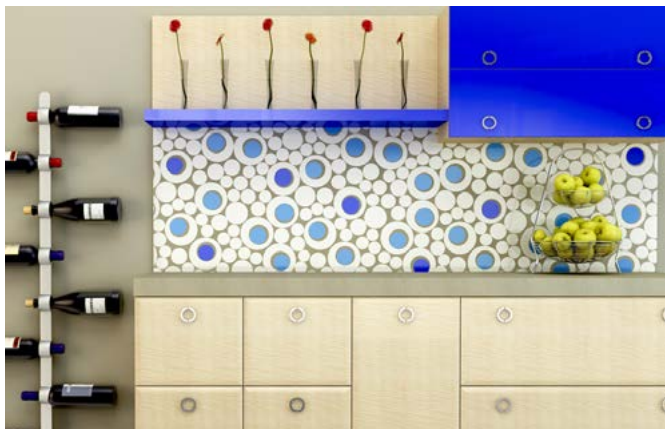

8648 Glenmont Drive, Suite 150
Houston, Texas 77036







[CALL/TEXT] 713.839.8586
[TOLL FREE] 800.788.4450





sales@cabinethardware.com



www.cabinethardware.com

Sample Part No.	Name		Door Style	Matching Back Sq. Ft. Price
Standard Wood Veneer				
800326	Plain Sliced Red Oak		Metro	\$17 ⁸⁴
			Fusion	\$19 ⁴⁶
800324	Plain Sliced Maple		Metro	\$19 ⁴⁶
			Fusion	\$20 ⁹²
800325	Plain Sliced Alder		Metro	\$25 ⁹⁰
			Fusion	\$28 ²⁴
800325	Plain Sliced Cherry		Metro	\$22 ⁵²
			Fusion	\$24 ⁰⁶

Reconstituted Wood Veneer				
800326	Recon Quartered Walnut		Metro	\$39 ⁵⁷
			Fusion	\$42 ⁷¹
800327	Recon Gun Metal Ebony		Metro	\$39 ⁵⁷
			Fusion	\$42 ⁷¹
800327	Recon Rosewood		Metro	\$39 ⁵⁷
			Fusion	\$42 ⁷¹

Part No.	Description	Detail	Price
Options			
800332	Hinge Boring	Standard	\$2 ⁷⁵ per hole
		Custom	\$4 ⁵⁰ per hole
800333	Fingerpulls	Standard pattern and placement	\$2 ⁷⁵ per component
n/a	Grain Direction	Horizontal	\$2 ⁷⁵ per sq. ft.

Doors & Fronts	Door/Drawer Minimum		Maximum*	
	Width	Height	Width	Height
Metro & Fusion	6"	6"	30"	72"

* While Northern Contours manufacturing capabilities allow them to go to 30" x 72", product over 72" long will not be covered by their warranty. It's highly recommended using multiple doors instead. If you do order unwarranted product over 72", they recommend using additional hinges to help control any warping that may occur. Oversize fees may apply.

- Freight is included in price.
- Production lead time: 10-15 working days depending on volume and product for production ready products.
- A one square foot minimum charge applies to each piece.
- Vertical grain direction is standard for both doors and drawer fronts. Horizontal grain direction available for an upcharge.
- Components manufactured by Northern Contours are warranted against defects occurring in the manufacturing process and delamination or surface discoloration for 5 years from the date of purchase.



SAMPLE BOARDS
Measure: 4" x 6"
Take home a sample board to compare colors with the rest of your project at a small cost.

Wood Veneer Series

Product Information



VENEER VARIANCE

Since many selections use natural wood veneer, some color and character variations will be visible from piece to piece, and order to order. Doors may have some crossbar figure or slight blending ray fleck. They are considered natural characteristics of the wood, and will not be replaced without a charge. Standard HPVA specifications are used to base the veneer grades.



VENEER CUTS - PLAIN SLICED

Plain sliced veneer is cut straight through the log from one side to the other producing the common cathedral grain pattern. This slicing method will create some areas with a straight grain appearance on the outside portions of the veneer.

RECONSTITUTED VENEER

Reconstituted veneer is an engineered product that provides color and grain consistency while also offering an environmentally responsible alternative to endangered or extremely rare wood species.



VENEER CUTS - QUARTERED

In quarter sawn, the quarter of a log is placed so that the growth rings are perpendicular to the cutting blade creating a straight grain pattern.

PLAIN SLICED RED OAK

- Face: "A" grade plain sliced heartwood
- Back: #2 grade veneer; some sapwood acceptable
- Edgebanding: Red Oak
- Characteristics: Light tan to pinkish-brown in color; veneer is coarse textured with straight grain pattern.

PLAIN SLICED MAPLE

- Face: "A" grade plain sliced sapwood
- Back: #2 grade veneer; some sapwood acceptable
- Edgebanding: Maple
- Characteristics: Ranges in color from white to creamy white and may have a pinkish tinge; veneer may contain slight curly or crossfire figure.

PLAIN SLICED ALDER

- Face: "A" grade plain sliced heartwood
- Back: #2 grade veneer; some sapwood acceptable
- Edgebanding: Alder
- Characteristics: Pinkish-brown in color; veneer fine textured with a subdued grain pattern; pin knots are allowed, 1/8" maximum, blending color, with no more than 2 per square foot on face veneer and unlimited on back veneer.

PLAIN SLICED CHERRY

- Face: "A" grade plain sliced heartwood
- Back: #2 grade veneer; some sapwood acceptable
- Edgebanding: Cherry
- Characteristics: Ranges in color from light pinkish-brown to dark reddish-brown.

RECONSTITUTED QUARTERED WALNUT

- Face and Back: Reconstituted veneer
- Edgebanding: Walnut
- Characteristics: Color ranges from light gray-brown to chocolate-brown to purplish-brown; veneer has a straight, consistent grain pattern.

RECONSTITUTED GUN METAL EBONY

- Face and Back: Reconstituted veneer
- Edgebanding: Reconstituted Gun Metal Ebony
- Characteristics: Color ranges from medium to dark grayish-brown with almost black veins; veneer has a straight, consistent grain pattern.

RECONSTITUTED ROSEWOOD

- Face and Back: Reconstituted veneer
- Edgebanding: Reconstituted Wenge
- Characteristics: Ranges in color from brown to dark violet-brown with darker purple-black lines; veneer has a straight, consistent grain pattern.

MANUFACTURING TOLERANCE

All components are ordered to the nearest 1/32". Northern Contours manufacturing tolerance is +/- 1/32" in width and height. The squareness tolerance is 1/16" from corner to corner. The finished component thickness is 0.785" +/- 0.015".

Door Height Range	Maximum Bow
0" to 24"	1/16"
24" to 48"	1/8"
48" to 72"	1/4"
72" and over	not warranted for warp

WARP MEASUREMENT

Warp tolerance is measured by placing the component on a flat surface with the bow side down. Measure the distance between the flat surface and the component at its highest point. Determine if the deflection falls within stated tolerance for that size and style of component.

FINGERPULLS SPECIFICATIONS

The standard placement for fingerpulls on doors is top and bottom and on drawer fronts is top OR bottom. The standard fingerpull is 4" long and centered with a 1/4" thickness and depth. All fingerpulls are machined according to the following drawings.

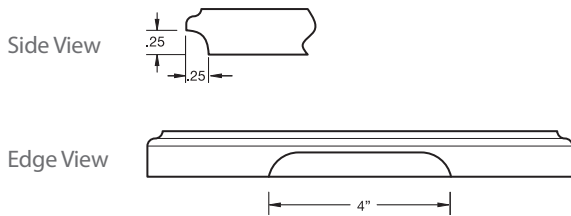

HINGE BORING SPECIFICATIONS

Two patterns available below. Unless otherwise specified, Pattern 1 is standard.

Hinge Boring Patterns

Pattern 1 (Standard)

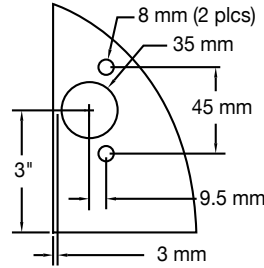

Hinge Pattern 1 has a 35 mm bore and two 8 mm holes for dowels 1/2" (12.7 mm) deep

Pattern 2

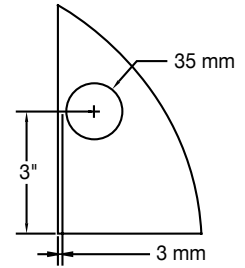

Hinge Pattern 2 has a single 35 mm hole 1/2" (12.7 mm) deep

Standard Hinge Placement

Door Heights

