



### Sometimes it's better to blend in.

You know how difficult it is to blend functional requirements with style. Take large metal return-air grilles. To work effectively, they have to be centrally located and unobstructed. The fact is, these unsightly grilles have always been a design challenge.

But now you have an inexpensive way to upgrade the look of any home project. Worth Home Products sets a new standard with its wooden return air grilles, providing a quality alternative to stamped metal grilles. They paint beautifully to blend into any wall or ceiling.

What's more, our design contributes style with safety, versatility and performance. Its patent-pending locking system provides a secure installation and a simple operation for filter replacement, cleaning or duct inspection all with no moving hardware.

Using a Worth Home Products' grille also makes economic sense. Our superior design and construction requires no special preparation to the grilles or modifications to standard return-air openings. And of course they are engineered to ensure proper air flow so HVAC systems can work effectively. Site-built grilles are no match.



Baltic Birch Grille



Primed Baltic Birch Grille



Part No.	Status	Dimensions
<b>Primed Baltic Birch (Paintable)</b>		
418800	STOCK	12" W X 12" H
418801	STOCK	12" W X 24" H
418854	SPEC	12" W X 36" H
418802	SPEC	14" W X 14" H
418803	SPEC	14" W X 20" H
418804	SPEC	14" W X 25" H
418805	SPEC	14" W X 30" H
418806	SPEC	16" W X 16" H
418857	SPEC	16" W X 20" H
418807	STOCK	16" W X 25" H
418808	SPEC	18" W X 18" H
418809	SPEC	20" W X 20" H
418810	STOCK	20" W X 25" H
418811	STOCK	20" W X 30" H
418865	SPEC	24" W X 36" H
418814	SPEC	25" W X 20" H
418815	SPEC	30" W X 20" H
<b>Select Baltic Birch (Stainable)</b>		
418830	SPEC	12" W X 12" H
418831	SPEC	12" W X 24" H
418817	SPEC	12" W X 36" H
418833	SPEC	14" W X 14" H
418834	SPEC	14" W X 20" H
418836	SPEC	14" W X 25" H
418837	SPEC	14" W X 30" H
418838	SPEC	16" W X 16" H
418820	SPEC	16" W X 20" H
418839	SPEC	16" W X 25" H
418821	SPEC	16" W X 36" H
418840	SPEC	18" W X 18" H
418842	SPEC	20" W X 20" H
418843	SPEC	20" W X 25" H
418844	SPEC	20" W X 30" H
418847	SPEC	24" W X 12" H
418848	SPEC	24" W X 24" H
418825	SPEC	24" W X 36" H
418850	SPEC	25" W X 20" H
418851	SPEC	30" W X 20" H

## Product Description

Two-part assembly - a removable wooden grille that fits inside the standard-sized metal frame. All styles are removable for easy filter replacement, duct inspection or cleaning, and install securely with a patent-pending locking system. **Use the primed for painting or the select for staining.**

## The Worth Advantage

Backed by satisfaction guarantee, no other wooden grille provides superior quality, style, performance or safety.

## How To Install

Follow these simple steps to install your wooden grille in any wall or ceiling. We recommend you prime and paint your grille.

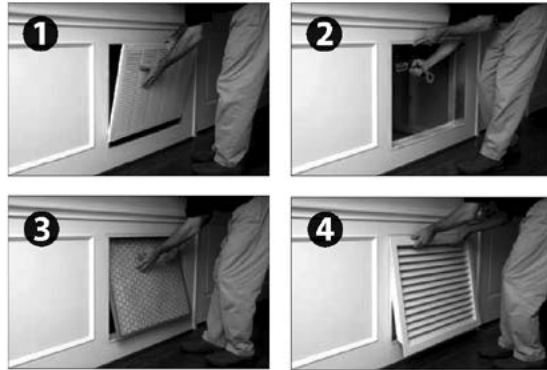

- 1 After removing your old metal grille, simply insert our metal frame into the prepared opening.
- 2 Screw the frame into the adjacent studs. The side flanges will help ensure a flush mount.
- 3 Insert a filter if your system requires one at the return-air opening.
- 4 Then simply guide the grille into place assisted by the frame's built-in spring.

\* SPEC: Allow an additional 7-10 days to ship.